



## FA001PIN

Support :



### Key Features

- Lens: 3.7mm Taper Pinhole Lens
- Dimension:  $\phi$  20x62(H)mm

### CONNECTION

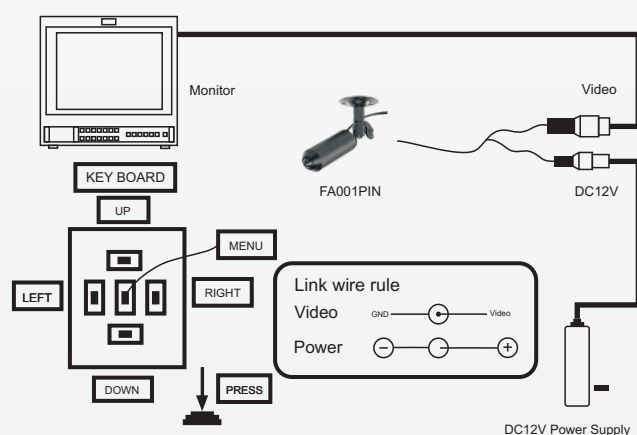

## FA001PIN Analog CCTV Camera

<b>Image Sensor</b>	1/3" SONY ICX639BK CCD
<b>Lens</b>	3.7mm Taper Pinhole Lens 2M pixels
<b>Electronic Shutter</b>	Auto:PAL 1/50-1/100,000Sec;NTSC 1/60-1/100,000Sec
<b>TV System</b>	PAL / NTSC
<b>HoriZontal Resolution</b>	650TVL
<b>Effective Pixel</b>	PAL:625 Lines, 50 Field/Sec;NTSC:525 Lines, 60 Field/Sec
<b>IR Distance</b>	-
<b>IR Status</b>	-
<b>IR Power ON</b>	-
<b>Usable Illumination</b>	-
<b>S/N Ratio</b>	-
<b>Power</b>	DC12V $\pm$ 10%, 150mA
<b>Temperature</b>	-20°C~+60°C Rh95% MAX
<b>Ready Use</b>	Indoor
<b>Others</b>	Housing IP65